



## Hard Top Campsite Caravan Ride Dirt Camper Van Dirt Caravan Adventure Travel Large Caravan Ride

Our Product Introduction

for more products please visit us on [huazhiyurv.com](http://huazhiyurv.com)

### Basic Information

- Place of Origin: China
- Brand Name: HuaZhiyu
- Model Number: 21
- Minimum Order Quantity: 1
- Payment Terms: T/T



### Product Specification

- Size: 28 Meters
- Customize: Support All-round Customization
- Highlight: Campsite Caravan, Ride Dirt Camper Van, Travel Large Caravan



### More Images

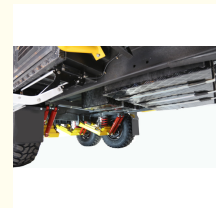

### Product Description

Hard Top Campsite Caravan Caravan Ride, Dirt Camper Van, Dirt Caravan Comfort, Adventure Travel, Large Caravan Ride

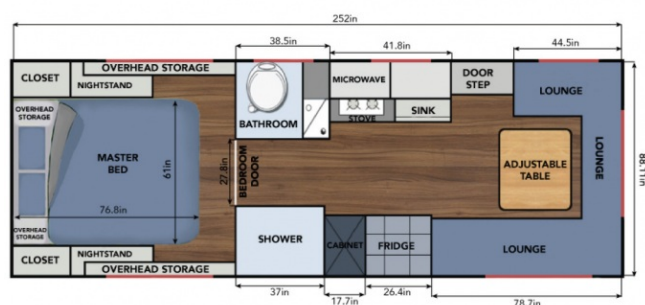

The pinnacle. The perfect blend of elegance, robustness and comfort, build quality and durability, while also featuring modern aerodynamic design. This campervan is a class changer in its own right, bringing a new benchmark to the industry. Experience the luxury and confidence of land!

Our Product Introduction



#### Suspension system

Has the most powerful independent suspension system. We have developed our own custom-designed trailing arm that allows each wheel to move independently for a smoother, more stable ride, whether on the highway or on rough terrain. Our quad suspension design spreads the load across four shocks instead of two, resulting in a smoother ride, safer operation, and longer suspension life.



#### appearance

It has a stand-alone suspension design that stands out from the rest. The design has been adapted to a dual-axle design to help distribute weight more evenly and maintain a smooth, stable ride for safer traction. , the biggest, the greatest travel trailer. Plates with bottom reinforcement and a crash-proof bar to maintain its beauty in rough road conditions.



#### indoors

Offering the most elegant and luxurious trailers. Everything couples need for long journeys. The interior is truly fit for Hollywood stars. Equipped with a full-size refrigerator, stove, oven, microwave, separate toilet and shower. Five-star wood veneer gives the interior an atmosphere of elegance never before seen in a 28-meter trailer.



High-gloss wooden enamel cabinets and seats fit for Hollywood stars. Full bathroom including separate toilet, shower and wash basin.



Full kitchen including stove, oven, microwave and full refrigerator.



Space, luxury, comfort, the latest sustainable technology, with everything you need.



We are a production and trading company, you can tell us your needs, target products, suggestions or opinions, we will carry out a full range of customized services according to your description

#### Exterior

- Material: aluminum-plastic panel + aluminum-shaped panel
- Stone baffles / bumpers: protect the underside of the motorhome
- Insulation: R16 foam insulation panels are used for the roof and bodywork
- Roof: Monolithic aluminium panel + roof ventilation window
- Ceiling: Made of special canvas with mesh windows outdoors
- Windows: 3 European windows with insect screens and privacy blackout curtains
- Awning: Manual awning with 2 brackets
- Toolbox: Extra-large storage space, front toolbox with 2 gas canisters rack and 2 drum holders
- Bar: Lockable folding bar
- Kitchen: stainless steel sink, gas stove and large prep table
- Shower: Outdoor cold/hot showerhead

#### Interior

- Bathroom: Separate wet and dry bathroom
- Lounge: Furnished with dining table and premium leather sofa that converts into a bed
- Kitchen: equipped with stove, sink, microwave and refrigerator
- Sleeping structure: 1x double bed and 1x sofa bed
- Flooring: Wood grain floor leather
- Cabinets: Malaysian lightweight wood with modern 5-star wood grain finish. All cabinets are used
- Gas spring-supported with push-open travel lock and drawer
- Faux leather: Khaki premium faux leather
- Doors: with multiple safety locks and separate built-in screen doors electricity
- Power system: 12V/220V power system with custom Black Series bands
- 2000W inverter and control panel
- Battery: 4x100AH deep cycle battery
- Solar panels: High-efficiency monocrystalline flexible solar panels are installed on the roof of the vehicle, up to 600W
- Interior lighting: Bedrooms and living rooms are equipped with LED reading lights
- Exterior lighting: Width/marker lights and front/rear LED headlights are installed on both sides of the body
- Outlet: Internal/external 12V/USB outlet
- Mains: 30A outlet
- Control panel: circuit breaker, digital meter and power readings
- MEASUREMENTS SLEEPS 4 PIPELINE
- Bathrooms: outdoor bathroom tent and indoor-asana fiberglass bathroom
- Water basin: large indoor bowl basin and outdoor stainless steel basin
- Toilet: Ceramic toilet
- water tank
- Drinking tank: 60L, triple filtration system
- Clean water tank: 240L, with aluminum plate to protect the water tank
- Grey water tank: 100L, with aluminum plate to protect the water tank
- Black water tank: 100L, with aluminum plate to protect the water tank
- Appliances/Accessories
- Refrigerator: 6 cu. ft. refrigerator
- Stoves: Outdoor and indoor gas stoves
- Range hood: Thin and light double fan range hood with light
- Gas: 2x20L gas canister
- Microwave: x1
- Heater: 16,000BTU thermostat control
- Air conditioning: Dometic overhead air conditioning
- Safety features: fire extinguisher, smoke alarm and gas/carbon oxide alarm
- Entertainment system: CD/FM/iPOD/Bluetooth/USB enabled radio
- 2x speakers indoors
- 2x marine-grade horns on the outside of the vehicle
- 24" TV with DVD capability
- Antenna: HDTV antenna with built-in safety lock

chassis

Traction frame/chassis: made of hot-dip galvanized steel tubes, and the key parts are welded with reinforcing plates

Independent suspension: Each cantilever is equipped with twin shock absorbers and coil springs

Tires: 265x75x R16 off-road all-terrain tires with two spare tires as standard

Wheels: 16-inch iron wheels with a black coating

Brakes: 12-inch electric brake + handbrake, the braking system includes 2 safety chains

TRACTOR: AUSTRALIAN ADR CERTIFIED OFF-ROAD TRACTOR WITH BLACK SERIES LOGO

Signal light connector: 7-pin plug

Anderson plug: 50 A

Guide Wheels: Off-road, oscillating heavy-duty 10" guide wheels

Trailer rings: 2 trailer rings at the rear of the body

Interior height: 1.9m

Interior length: 6.4m

Exterior body length: 8.6m

Exterior body width: 2.3m

Exterior vehicle height: 3.15m

Net weight: 2940KG

FRONT WEIGHT: 290KG

TOTAL WEIGHT: 3500KG



**Sichuan Huazhiyu Technology Co., Ltd**



yuguanhua86@gmail.com



huazhiyuv.com

Taiping Road, Tianfu New District, Chengdu, Sichuan, China